

FLEXIBLE GLAZING SYSTEM

SI5200FGS • SI5250FGS • SI5300FGS

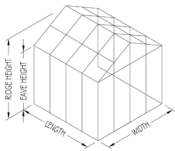

SI5000 FGS series thermally enhanced aluminum glazing system can be utilized in commercial and residential applications. This veneer glazing system can be fastened to almost any capable sub-structure for a minimized profile depth. This system can also be used for greenhouses, skylights, canopies, curtain walls, and other structures.



Straight Eave
Double Pitch

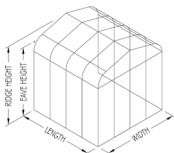

Curved Eave
Double Pitch

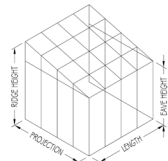

Straight Eave
Lean to

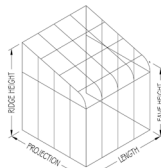

Curved Eave
Lean to

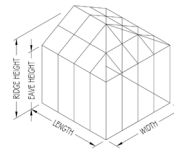

Hip End

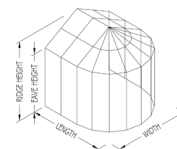

8 Sided
Conservatory

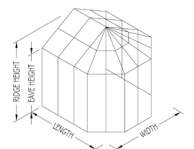

Conservatory
Nose

FEATURES

- 2", 2.5", 3" face widths
- Thermally enhanced aluminum profiles
- Overlapping construction creates positive drainage within profiles
- Glazing infills from $\frac{3}{16}$ " to $1\frac{1}{8}$ "; thicker glass options depending upon engineering
- Standard Finishes
 - Duracron: Hartford Green, Bronze, Black, Natural Clay, White, Sandstone
- LEED friendly system including recycled content
- Designed and manufactured in the U.S.A.
- System requires capable substructure for fastening

OPTIONS

- Large missile impact tested
- Cover cap options
- Custom aluminum finishes
 - Class I anodized: Dark Bronze, Clear
 - Powder coat finish: AAMA 2604-05
 - Fluoropolymers: 50% or 70%
 - Metal cladding
- Turn-key solutions for greenhouses, pool enclosures, and sunrooms



SYSTEMS

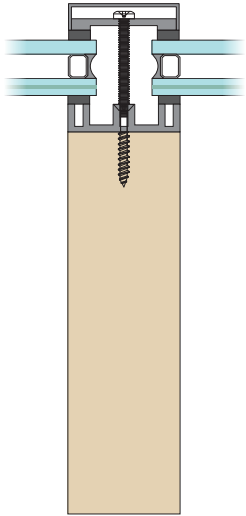

G2 2" Flexible Glazing System

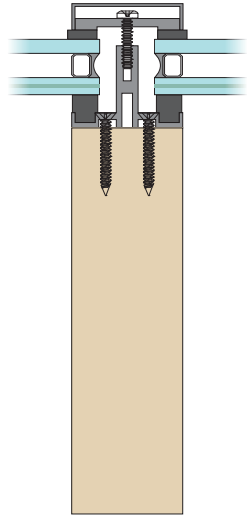

2" Vertical Glazing Adapter

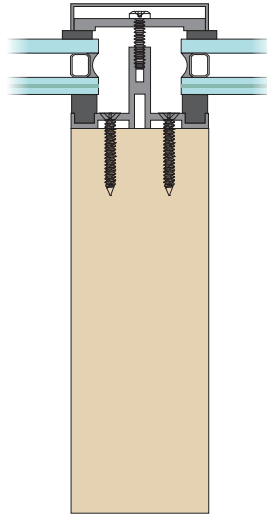

2 1/2" Vertical Glazing Adapter

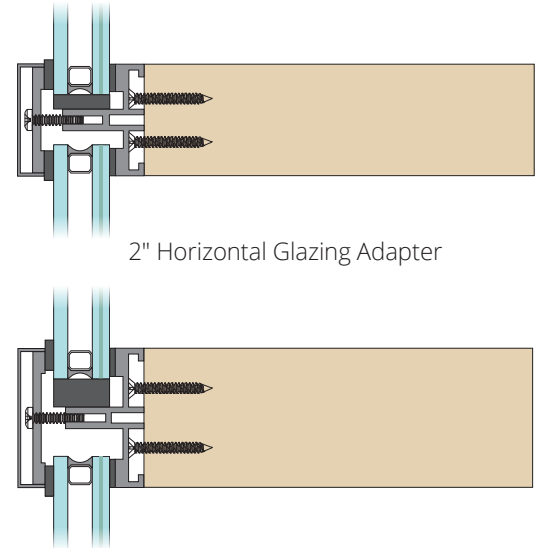

2" Horizontal Glazing Adapter

2 1/2" Horizontal Glazing Adapter

SILLS

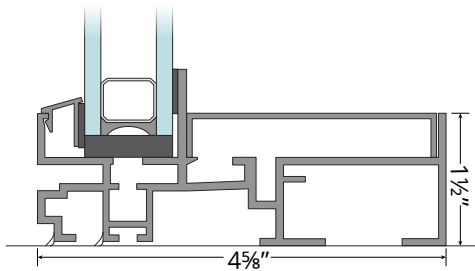

Standard Sill

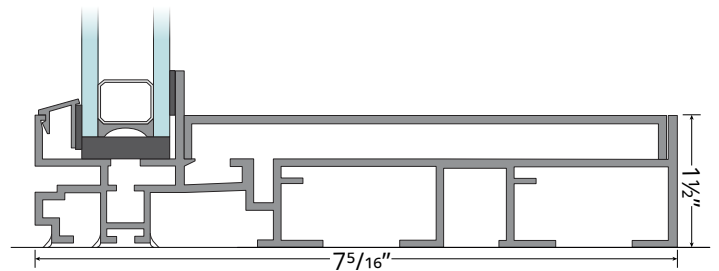

Heavy Sill

FINISH OPTIONS

Paint AAMA 2603 (5 year warranty). Finishes available while in stock.



Anodized Additional cost



Powder Coat Solids STANDARD - AAMA 2605 (10 year; up to 20 year warranty). Scratch & fade resistant; contains no VOCs.*



Powder Coat Solids PREMIUM - AAMA 2605 (10 year; up to 20 year warranty). Scratch & fade resistant; contains no VOCs.*

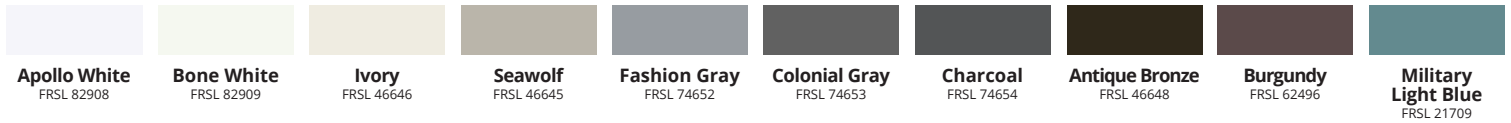

Visit <https://www.ifscoatings.com/content/assets/Uploads/brochures/IFS-Architectural-Digital-Color-Card.pdf> for additional metallic and anodic finishes.

Metal Clad STANDARD* (EXTERIOR ONLY)



Metal Clad PREMIUM*



*Lead times subject to availability. ** Special order.

Note: Depending upon color selection, additional charges and increased lead times may apply. Extended warranties and service plans are available for an additional charge. Examples are shown as accurate as photography and printing processes allow. Final finish selection should be made from a physical sample; contact Solar Innovations® for samples. Product and finish options are subject to vendor availability. Solar Innovations® reserves the right to discontinue any option at any time without notice. Additional options, including custom color match, are available; contact Solar Innovations® for details.

GLASS SPECIFICATIONS

	Overall Unit Thickness	U-Value	R-Value	Solar Heat Gain Coefficient	Visible Light Transmission	Reflectance Out	Reflectance In	UV Transmittance
DOUBLE GLAZED Outside Lite/Inside Lite								
Clear/Clear	1"	0.46	2.17	0.78	82%	15%	15%	58%
180/Clear	1"	0.26	3.85	0.64	79%	15%	15%	29%
272/Clear	1"	0.25	4.00	0.41	72%	11%	12%	16%
366/Clear	1"	0.24	4.17	0.27	65%	11%	12%	5%
340/Clear	1"	0.25	4.00	0.18	39%	11%	13%	2%
180/i89	1"	0.21	4.76	0.62	77%	15%	14%	27%
272/i89	1"	0.20	5.00	0.41	70%	11%	11%	16%
366/i89	1"	0.20	5.00	0.27	63%	11%	11%	5%
340/i89	1"	0.20	5.00	0.17	38%	11%	12%	2%
Gray/Clear	1"	0.45	2.22	0.60	57%	9%	13%	32%
Gray/180	1"	0.26	3.85	0.49	53%	9%	14%	17%
Gray/272	1"	0.25	4.00	0.38	50%	8%	9%	10%
Bronze/Clear	1"	0.45	2.22	0.62	61%	10%	13%	31%
Bronze/180	1"	0.26	3.85	0.61	59%	10%	14%	17%
Bronze/272	1"	0.25	4.00	0.39	54%	8%	10%	10%
SolarBan 60/Clear	1"	0.24	-	0.39	70%	11%	12%	20%
SolarBan 70/Clear	1"	0.24	-	0.27	64%	14%	13%	6%
SolarBan 90/Clear	1"	0.24	-	0.23	51%	12%	19%	8%
TRIPLE GLAZED Outside Lite/Middle Lite/Inside Lite								
180/Clear/180	1 1/8"	0.15	6.67	0.56	70%	20%	20%	13%
272/Clear/180	1 1/8"	0.15	6.67	0.37	63%	15%	18%	8%
366/Clear/180	1 1/8"	0.15	6.67	0.25	57%	14%	18%	2%
340/Clear/180	1 1/8"	0.15	6.67	0.16	34%	13%	19%	1%

To find out more about the features and options of our folding glass walls, visit our website at solarinnovations.com/folding-glass-walls/ or contact one of our sales designers at 800 618 0669.

COVER CAPS

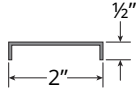

Flat

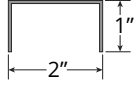

1" Flat

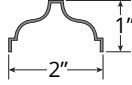

Ogee

ROUTED EDGES



3/8" Roundover

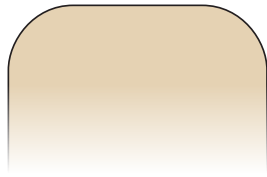

1/2" Roundover

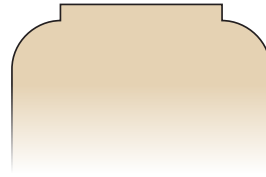

3/8" Roundover with Fillet

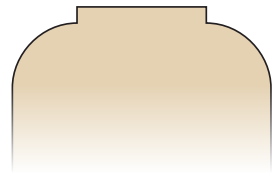

1/2" Roundover with Fillet

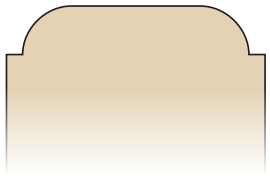

3/8" Thumbnail

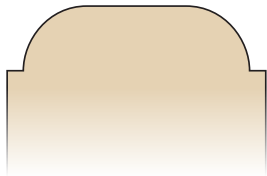

1/2"x 3/4" Thumbnail

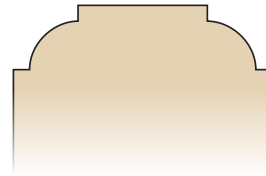

3/8" Bead

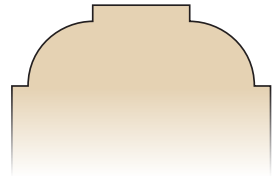

1/2" Bead

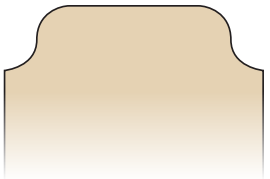

1/4" Roman Ogee

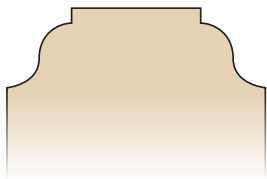

1/4" Roman Ogee with Fillet

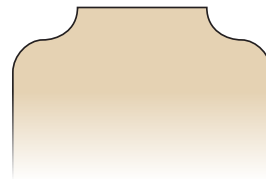

1/4" Ogee

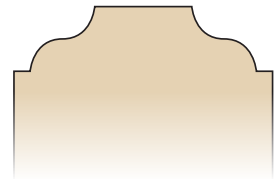

1/4" Ogee with Fillet

TESTING

2 1/2" Wood Curtain Wall – Air, Water and Structural Testing

Curtain Wall Features	Size	Air Infiltration @6.24psf per ASTME283	Water Resistance per ASTM E331/ ASTME547	Uniform Load Deflection* +/-40.0psf	
				Positive	Negative
Wood species: Ash Glulam Glazing: 1" IGU (1/4" tempered over 1/2" air space over 1/4" tempered) Weeps: 5/16" weep holes located 8" from ends	223 1/2" wide x 128 1/2" tall	0.02 CFM/ft ²	15psf	Vertical Member: 0.334"	Vertical Member: 0.354"
				Horizontal Member: 0.133"	Horizontal Member: 0.140"

* No glass breakage or permanent damage.

Individual components cannot be certified.
Only complete assemblies can be certified, as manufactured by Solar Innovations®, Inc.

Please be sure to visit our website for additional product information.

solarinnovations.com